

Parallel Keys

A machine element on shafts to connect & retain components such as gear drives & pulleys

Standard Parallel Keys

Parallel keys are stocked in C45k key steel, with a minimum tensile strength of 60Kg/mm². Stainless Steel grade A4 is also available to order.

Standard	Type
DIN 6885A / ISO 2491A / B46 TYPE A	Round Ended
DIN 6885B / ISO 2491B / B46 TYPE B	Square Ended
DIN 6885AB / ISO 2491AB / B46 TYPE AB	One Round / One Square Ended

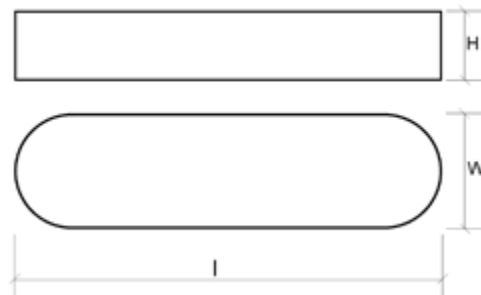

Custom-Made Parallel Keys

We are also a UK manufacturer of custom-made and non-standard parallel keys which can be made to customer specifications or drawing.

BS 46 (Imperial)

Width 'W'	1/8	5/32	3/16	1/4	5/16	3/8	7/16	1/2
Height 'H'	1/8	5/32	3/16	1/4	5/16	3/8	7/16	1/2
Length								
1/4								
5/16								
3/8								
1/2								
9/16								
5/8								
3/4								
7/8								
1								
1 1/8								
1 1/4								
1 3/8								
1 1/2								
1 3/4								
2								
2 1/4								
2 1/2								
3								
3 1/4								
3 1/2								
3 3/4								
4								



Materials:

- C45k Key Steel
- Stainless Steel A4

[View Woodruff Key Range](#)

[Request A Quote](#)

[Visit Our Website](#)

[Join Our Community](#)

TECHNIFAST

North Folds Road
Oakley Hay Industrial Estate
Corby, Northants, NN18 9AT

+44 (0) 1536 461140
sales@technifast.co.uk
www.technifast.co.uk



