

# TAPER PINS



Our standard range of plain taper pins are made to DIN 1B, we also offer extractable taper pins to DIN 7977 and 7978.

With DIN standards the nominal diameter is always the smaller end and the taper is 2% (1 in 50). We can also supply to other metric standards, inch sizes or completely non-standard dimensions. We also stock taper pins in inch sizes to BS46 Part 3. Please contact our sales team for further details.

## MATERIALS

MILD STEEL

STAINLESS 303

STAINLESS 316

## STANDARDS

|              |  |
|--------------|--|
| DIN 1A       | Plain taper pin with ground finish (surface roughness of 0.8 microns)        |
| DIN 1B       | Plain taper pin with turned finish (surface roughness of 3.2 microns)        |
| DIN 7978     | Extractable taper pin with female thread                                     |
| DIN 7977     | Extractable taper pin with male thread                                       |
| ISO 2339     | Same as DIN 1B but length includes crowns                                    |
| ISO 8736     | Same as DIN 7978 with minor tolerance changes                                |
| ISO 8737     | Same as DIN 7977 with minor tolerance changes                                |
| BS 46 PT 3   | Inch range, with nominal diameter being the large end and a taper of 1 in 48 |
| BS 1804 PT 3 | Extractable taper pin  |
| BS 5681      | Same as ISO 2339   |
| DIN 258      | Variant form of DIN 7977   |

## SPECIAL TAPER PINS

- Non-standard diameters up to 20mm maximum
- Non-standard taper angles
- Ground finish
- Lengths up to 190mm
- Other materials
- Split taper pins

# TAPER PINS – SIZE RANGE

## TAPER PINS TO DIN 1B

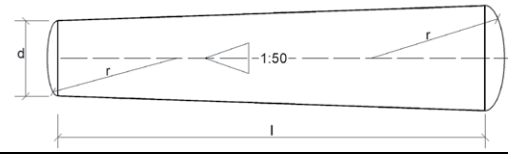

| Nominal Diameter (dimension 'd'), DIN 1B | 1.5  | 2   | 2.5 | 3    | 4   | 5    | 6   | 8   | 10  | 12  | 14  | 16  | 20  |
|--|------|-----|-----|------|-----|------|-----|-----|-----|-----|-----|-----|-----|
| Dimension 'C'                            | 0.23 | 0.3 | 0.4 | 0.45 | 0.6 | 0.75 | 0.9 | 1.0 | 1.2 | 1.6 | 1.6 | 2.0 | 2.5 |
| Lengths in mm                            |      |     |     |      |     |      |     |     |     |     |     |     |     |
| 6  |      |     |     |      |     |      |     |     |     |     |     |     |     |
| 8  |      |     |     |      |     |      |     |     |     |     |     |     |     |
| 10                                       |      |     |     |      |     |      |     |     |     |     |     |     |     |
| 12                                       |      |     |     |      |     |      |     |     |     |     |     |     |     |
| 14                                       |      |     |     |      |     |      |     |     |     |     |     |     |     |
| 16                                       |      |     |     |      |     |      |     |     |     |     |     |     |     |
| 18                                       |      |     |     |      |     |      |     |     |     |     |     |     |     |
| 20                                       |      |     |     |      |     |      |     |     |     |     |     |     |     |
| 22                                       |      |     |     |      |     |      |     |     |     |     |     |     |     |
| 24                                       |      |     |     |      |     |      |     |     |     |     |     |     |     |
| 26                                       |      |     |     |      |     |      |     |     |     |     |     |     |     |
| 28                                       |      |     |     |      |     |      |     |     |     |     |     |     |     |
| 30                                       |      |     |     |      |     |      |     |     |     |     |     |     |     |
| 32                                       |      |     |     |      |     |      |     |     |     |     |     |     |     |
| 36                                       |      |     |     |      |     |      |     |     |     |     |     |     |     |
| 40                                       |      |     |     |      |     |      |     |     |     |     |     |     |     |
| 45                                       |      |     |     |      |     |      |     |     |     |     |     |     |     |
| 50                                       |      |     |     |      |     |      |     |     |     |     |     |     |     |
| 55                                       |      |     |     |      |     |      |     |     |     |     |     |     |     |
| 60                                       |      |     |     |      |     |      |     |     |     |     |     |     |     |
| 65                                       |      |     |     |      |     |      |     |     |     |     |     |     |     |
| 70                                       |      |     |     |      |     |      |     |     |     |     |     |     |     |
| 80                                       |      |     |     |      |     |      |     |     |     |     |     |     |     |
| 90                                       |      |     |     |      |     |      |     |     |     |     |     |     |     |
| 100                                      |      |     |     |      |     |      |     |     |     |     |     |     |     |
| 110                                      |      |     |     |      |     |      |     |     |     |     |     |     |     |
| 120                                      |      |     |     |      |     |      |     |     |     |     |     |     |     |
| 130                                      |      |     |     |      |     |      |     |     |     |     |     |     |     |
| 140                                      |      |     |     |      |     |      |     |     |     |     |     |     |     |
| 150                                      |      |     |     |      |     |      |     |     |     |     |     |     |     |
| Length Tolerances to js 15               |      |     |     |      |     |      |     |     |     |     |     |     |     |

A selection kit is also available.

## EXTRACTABLE TAPER PINS

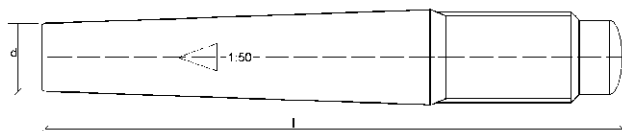
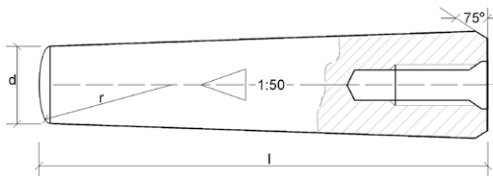

### DIN 7978 (ISO 8736) – FEMALE THREAD

| Nominal Diameter 'd', DIN 7978 | 6  | 8  | 10 | 12 | 14 | 16  | 20  |
|--------------------------------|----|----|----|----|----|-----|-----|
| Thread Size                    | M4 | M5 | M6 | M8 | M8 | M10 | M12 |
| Lengths                        |    |    |    |    |    |     |     |
| 16                             |    |    |    |    |    |     |     |
| 18                             |    |    |    |    |    |     |     |
| 20                             |    |    |    |    |    |     |     |
| 24                             |    |    |    |    |    |     |     |
| 26                             |    |    |    |    |    |     |     |
| 28                             |    |    |    |    |    |     |     |
| 30                             |    |    |    |    |    |     |     |
| 32                             |    |    |    |    |    |     |     |
| 36                             |    |    |    |    |    |     |     |
| 40                             |    |    |    |    |    |     |     |
| 45                             |    |    |    |    |    |     |     |
| 50                             |    |    |    |    |    |     |     |
| 55                             |    |    |    |    |    |     |     |
| 60                             |    |    |    |    |    |     |     |
| 70                             |    |    |    |    |    |     |     |
| 90                             |    |    |    |    |    |     |     |
| 100                            |    |    |    |    |    |     |     |
| 110                            |    |    |    |    |    |     |     |
| 120                            |    |    |    |    |    |     |     |
| Length Tolerances to js 15     |    |    |    |    |    |     |     |

### DIN 7977 – MALE THREAD

| Nominal Diameter 'd', DIN 7977 | 5  | 6  | 8  | 10  | 12  | 16  |
|--------------------------------|----|----|----|-----|-----|-----|
| Thread Size                    | M5 | M6 | M8 | M10 | M12 | M16 |
| Lengths                        |    |    |    |     |     |     |
| 40                             |    |    |    |     |     |     |
| 45                             |    |    |    |     |     |     |
| 50                             |    |    |    |     |     |     |
| 55                             |    |    |    |     |     |     |
| 60                             |    |    |    |     |     |     |
| 65                             |    |    |    |     |     |     |
| 70                             |    |    |    |     |     |     |
| 75                             |    |    |    |     |     |     |
| 80                             |    |    |    |     |     |     |
| 85                             |    |    |    |     |     |     |
| 90                             |    |    |    |     |     |     |
| 95                             |    |    |    |     |     |     |
| 100                            |    |    |    |     |     |     |
| 110                            |    |    |    |     |     |     |
| 120                            |    |    |    |     |     |     |
| 130                            |    |    |    |     |     |     |
| 140                            |    |    |    |     |     |     |
| 150                            |    |    |    |     |     |     |
| 160                            |    |    |    |     |     |     |
| Length Tolerances to js 15     |    |    |    |     |     |     |