

# SPLIT COTTER PINS

Our range of cotter pins are stocked in diameters 1mm to 13mm in mild steel (usually zinc plated), 1mm to 6.3mm in stainless steel A4 and brass.

Our specifications follow DIN 94, which is equivalent to ISO 1234 and BS 1574. Due to the loose fit required for cotter pins, the metric range doubles for inch sizes.

## MATERIALS

**MILD STEEL, ZINC PLATED**

**STAINLESS A4**

**BRASS**

## STANDARDS

**DIN 94 (stocked)**

**BS 1574**

**BS 7724**

**ISO 1234**



## SIZE RANGE – COTTER PINS

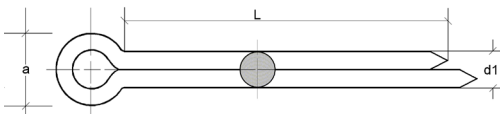

Nominal Diameter, Cotter Pins		1	1.2	1.6	2	2.5	3.2	4	5	6.3	8	10	13
Available Materials		Mild Steel, Zinc Plated Stainless Steel Brass									Mild Steel, Zinc Plated Only		
Dimension 'd1'	Max	0.9	1.0	1.4	1.8	2.3	2.9	3.7	4.6	5.9	7.5	9.5	12.4
	Min	0.8	1.09	1.3	1.7	2.1	2.7	3.5	4.4	5.7	7.3	9.3	12.1
Dimension 'a'	Max	1.8	2.0	2.8	3.6	4.6	5.8	7.4	9.2	11.8	15.0	19.0	24.8
	Min	1.6	1.7	2.4	3.2	4.0	5.1	6.5	8.0	10.3	13.1	16.6	21.7
Lengths in mm													
	6												
	8												
	10												
	12												
	16												
	18												
	20												
	22												
	25												
	28												
	32												
	36												
	40												
	45												
	50												
	56												
	63												
	71												
	80												
	90												
	100												
	112												
	125												
	140												
	160												