

CLEVIS PINS



We supply Clevis Pins to ISO 2341B (DIN 1444) which has a cross-drilled hole for R-Pins or Cotter Pins (see pages 18 and 19). Also available are ISO 2341 with grooves for Circlips to DIN 471.

When specifying Clevis Pins, it should be noted that the nominal length is the total length from under the head to the end of the pin, but the grip length is from under the head to the inside edge of the hole or groove. This is shown in the table under references L1 and G1.

STANDARDS

ISO 2341A	same as 2341 but without hole
ISO 2341B	our stocked programme
ISO 2341 – Circlip	(for Circlips to DIN 471)
ISO 2340A	Headless, without hole
ISO 2340B	Headless, with cross-drilled hole at each end
BS 5894	obsolete, replaced by ISO 2341
DIN 1433	Headless, with or without hole
DIN 1434	Similar to ISO 2341 but with smaller diameter head
DIN 1435	Similar to ISO 2341 but with larger diameter head
DIN 1436	Similar to ISO 2341 but with larger diameter head
DIN 1443	Same as ISO 2340
DIN 1444	Same as ISO 2341

MATERIALS

MILD STEEL, ZINC PLATED
STAINLESS A2
STAINLESS A4



SIZE RANGE – CLEVIS PINS

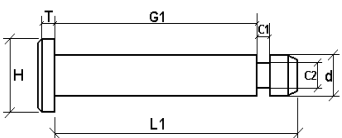
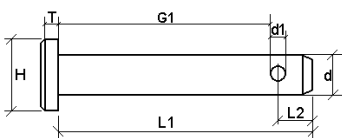

Nominal Diameter 'd'	5	6	8	10	12	14
Diameter Tolerance	h11					
Head Diameter 'H'	8	10	14	18	20	22
Hole Diameter 'd1'	1.6	1.6	2	3.2	3.2	4
Head Thickness 'T'	1.6	2	3	4	4	4
Circlip Groove 'C1'	0.7	0.8	0.9	1.1	1.1	1.1
Circlip Groove 'C2'	4.8	5.7	7.6	9.6	11.5	13.4
Length 'L2' min	2.9	3.2	3.5	4.5	5.5	6
Length 'G1'	L1 - L2 - 1/2 d1					
Lengths 'L1'						
10	6.7					
12	8.7	8				
14	10.7	10				
16	12.7	12	11.5			
18	14.7	14	13.5			
20	16.7	16	15.5	13.9		
22	18.7	18	17.5	15.9		
24	20.7	20	19.5	17.9	16.9	
26	22.7	22	21.5	19.9	18.9	
28	24.7	24	23.5	21.9	20.9	20
30	26.7	26	25.5	23.9	22.9	22
32	28.7	28	27.5	25.9	24.9	24
35	31.7	31	30.5	28.9	27.9	27
40	36.7	36	35.5	33.9	32.9	32
45	41.7	41	40.5	38.9	37.9	37
50	46.7	46	45.5	43.9	42.9	42
55		51	50.5	48.9	47.9	47
60		56	55.5	53.9	52.9	52
65			60.5	58.9	57.9	57
70			65.5	63.9	62.9	62
75			70.5	68.9	67.9	67
80			75.5	73.9	72.9	72
85				78.9	77.9	77
90				83.9	82.9	82
95				88.9	87.9	87
100				93.9	92.9	92
120					112.9	112
140						132
Length Tolerances	Up to 10 mm long ± 0.25		12 – 50 mm long ± 0.5		Over 50 mm long ± 0.75	

AVAILABLE TO ORDER

- Non-Standard dimensions
- Other materials

* ALSO AVAILABLE IN INCH SIZES